

# Leitchfield, Kentucky

Grayson County

Site 085-001

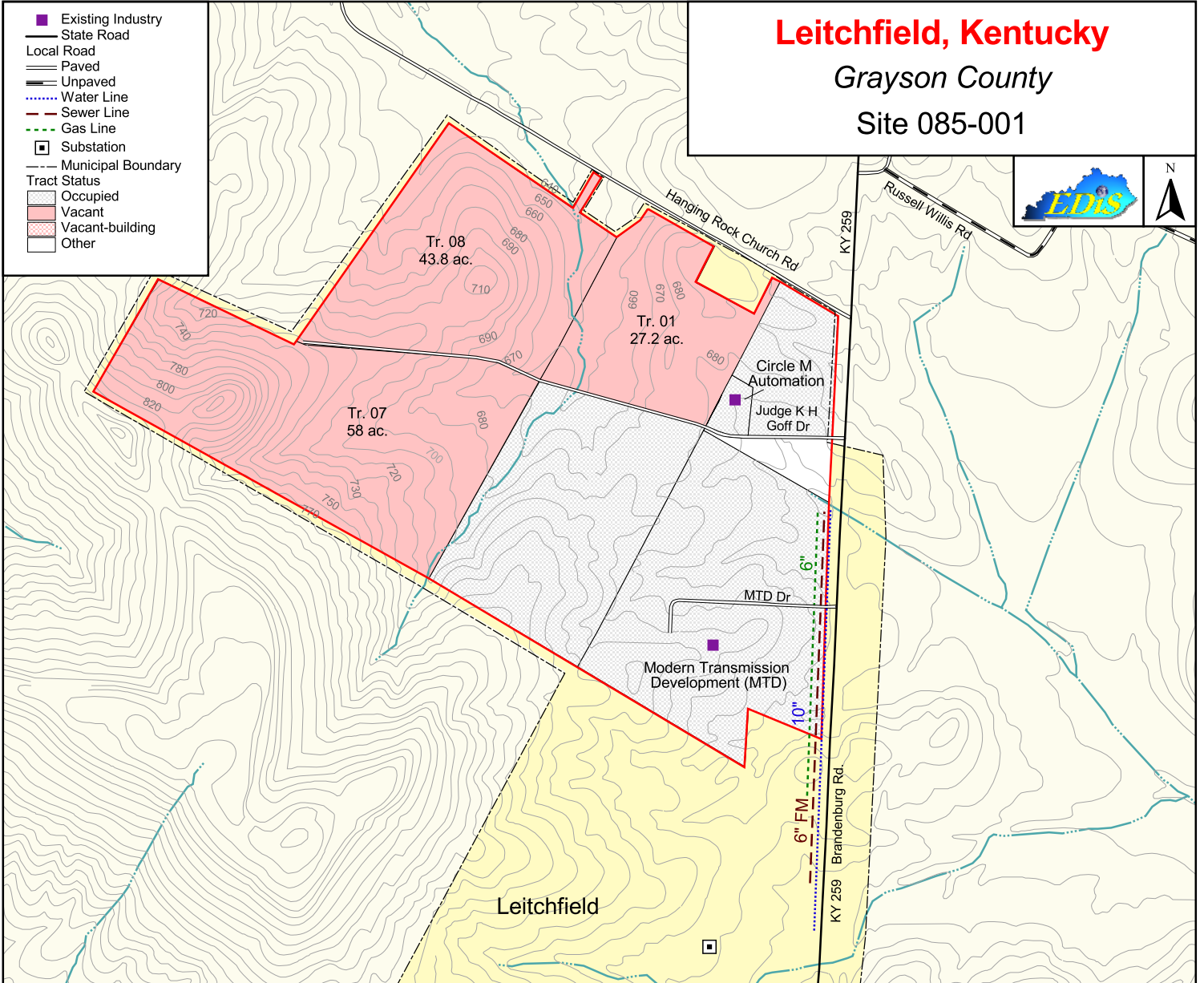

- Existing Industry
- State Road
- Local Road
- Paved
- Unpaved
- Water Line
- Sewer Line
- Gas Line
- Substation
- Municipal Boundary
- Tract Status
  - Occupied
  - Vacant
  - Vacant-building
  - Other

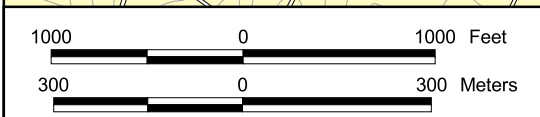

## Judge Kenneth H. Goff Industrial Park 129.0 Acres/52.2 Hectares

**LOCATION:** Within northern city limits of Leitchfield  
**ZONING:** I-2 (Heavy Industrial)  
**HIGHWAY ACCESS:** KY 259 adjacent to eastern boundary; Wendell H. Ford Western Kentucky Parkway interchange approximately 3.6 miles south via KY 259  
**COMMERCIAL AIR ACCESS:** Louisville International-Standiford Field  
Distance: 73 miles northeast of site  
**RAIL:** Not rail served  
**WATER:** Leitchfield Utilities  
Size Line: 10-inch line on site  
**SEWER:** Leitchfield Utilities  
Size Line: 6-inch force main line on site  
**NATURAL GAS:** Leitchfield Utilities  
Size Line: 6-inch line on site  
**ELECTRICITY:** Warren RECC  
**BROADBAND (Type:Service):** Cable: Comcast Cable, Mediacom; DSL: Alltel  
**FLOOD DATA:** Not in 100-year flood plain  
**OWNERSHIP:** City of Leitchfield  
**SCHOOL DISTRICT:** Grayson County Schools  
**PRICE PER ACRE:** Tract 01 \$8,000; Tract 07 \$10,000

# Leitchfield, Kentucky

## Grayson County



- Child Care
- Fire Station
- Parkway
- US Highway
- State Road
- Local Road
- Paved
- Unpaved
- Rail
- Sewer Treatment Plant
- Municipal Boundary
- Tract Status**
- Occupied
- Vacant
- Vacant-building
- Other

