

BORING NUMBER	SURFACE ELEVATION	REFUSAL DEPTH
B-1	855.0 FT.	15.7 FT. *
B-2	825.0 FT.	20.5 FT. *
B-3	844.0 FT.	20.5 FT. *
B-4	825.0 FT.	20.5 FT. *
B-5	840.0 FT.	15.8 FT.
B-6	848.0 FT.	16.5 FT.
B-7	861.0 FT.	20.5 FT. *
B-8	845.0 FT.	20.5 FT. *
B-9	825.0 FT.	20.5 FT. *
B-10	847.0 FT.	20.5 FT. *
B-11	857.0 FT.	20.5 FT. *
B-12	855.0 FT.	20.5 FT. *
B-13	863.0 FT.	20.5 FT. *
B-14	861.0 FT.	20.5 FT. *
B-15	880.0 FT.	40.5 FT. *
B-16	855.0 FT.	20.5 FT. *
B-17	855.0 FT.	20.5 FT. *
B-18	863.0 FT.	20.5 FT. *
B-19	861.0 FT.	20.5 FT. *
B-20	880.0 FT.	40.5 FT. *
B-21	855.0 FT.	25.5 FT. *
B-22	845.0 FT.	25.5 FT. *
B-23	873.0 FT.	20.5 FT. *
B-24	855.0 FT.	20.5 FT. *

The East Park Regional Industrial Park Site B, is a 615+ acre development owned and controlled by the Northeast Kentucky Regional Industrial Authority, Inc. The Property includes all access, infrastructure, restrictive deeds and covenants, beautiful landscaping and directional corporate signage. Acreage is available in different configurations to meet the needs of clients. Special areas have been dedicated for small businesses. For more information call 606/324-5111

**LEGEND**

- 8" GRAVITY SEWER
- 10" GRAVITY SEWER
- PROPOSED GRAVITY SEWER
- FORCE MAIN
- PROPOSED FORCE MAIN
- NATURAL GAS
- ELECTRIC
- 12" WATER LINE
- PROPERTY LINE
- UTILITY EASEMENT
- BOREHOLE
- WETLAND AREA/STREAM

- FUTURE BUILDINGS**
- FIRE STATION / WASTE MATERIALS
  - RESPONSE TEAM FACILITY
  - TRANSITIONAL OFFICE & CONFERENCE CENTER
  - DAY CARE CENTER
  - MAINTENANCE BARN
  - WAREHOUSE / STORAGE FACILITY

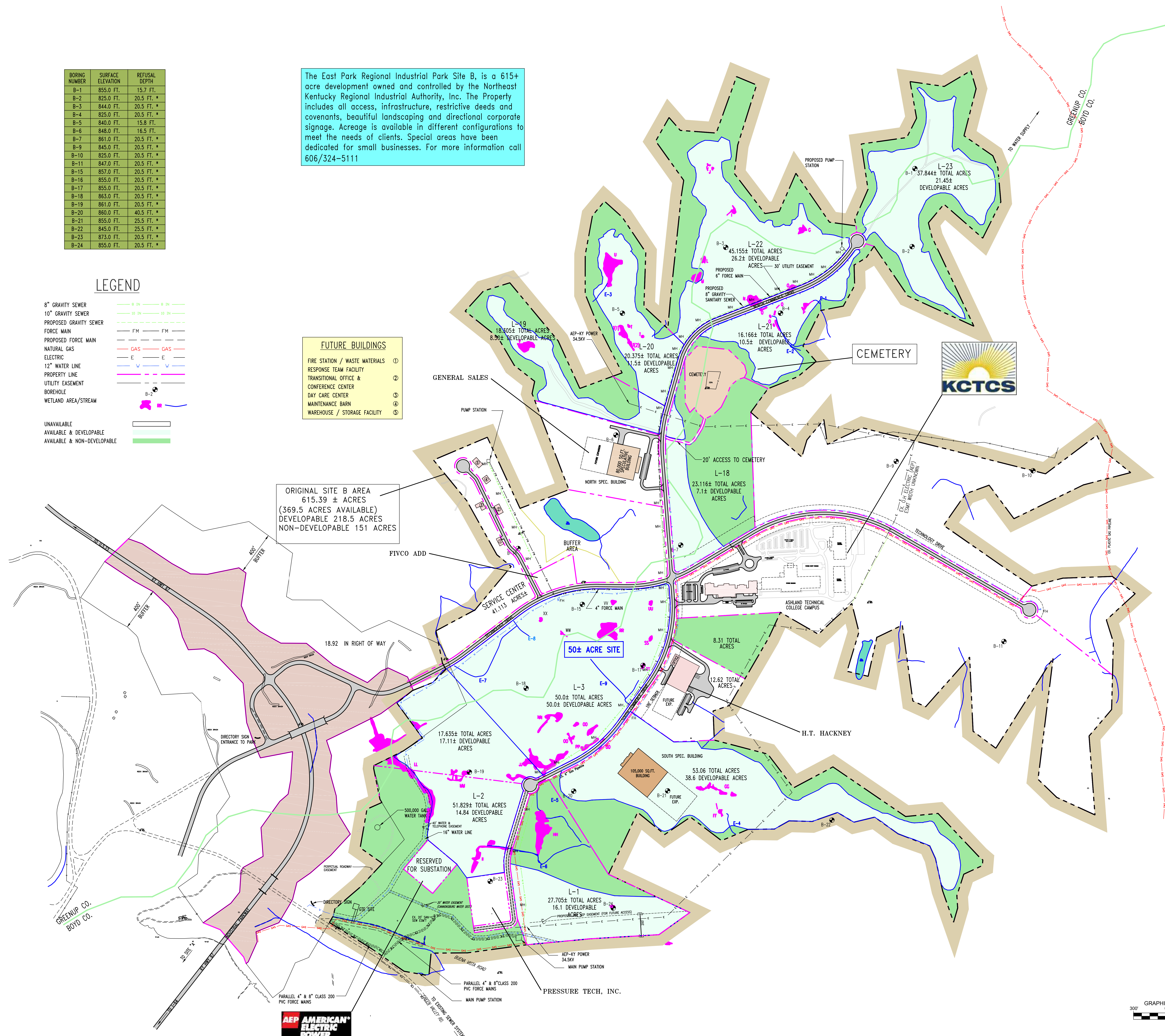

ORIGINAL SITE B AREA  
615.39 ± ACRES  
(369.5 ACRES AVAILABLE)  
DEVELOPABLE 218.5 ACRES  
NON-DEVELOPABLE 151 ACRES

50± ACRE SITE

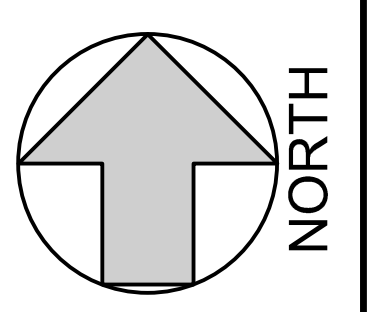
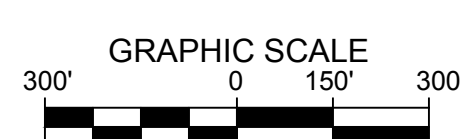

**MASTER DEVELOPMENT PLAN**  
EASTPARK SITE B  
BOYD & GREENUP COUNTIES

PROJECT NO.	DATE	REVISION
2007-02	10/27/06	ADDED UTILITIES, FUTURE BUILDINGS & LOSS
2007-02	11/20/06	ADDED NEW ROAD ALIGNMENT & NEW LOSS
2007-02	12/27/06	UPDATED ROAD & PROPERTY LINES
2007-02	04/27/07	ADDED PROPOSED LOSS & LOSS

**nse**  
Noble  
Smith  
&  
Ethridge  
INC.  
624 Washington Way  
Prestonsburg, KY 40363  
Phone: (606)323-5684  
Fax: (606)222-2007