

Elizabethtown, Kentucky

Hardin County

Building 093-027



- University/College
- Available Building
- Parkway
- US Highway
- State Road
- Local Road
- Paved
- Unpaved
- Rail
- Municipal Boundary
- 100 Year Flood Zone
- Tract Status
- Occupied
- Vacant
- Vacant-building
- Other

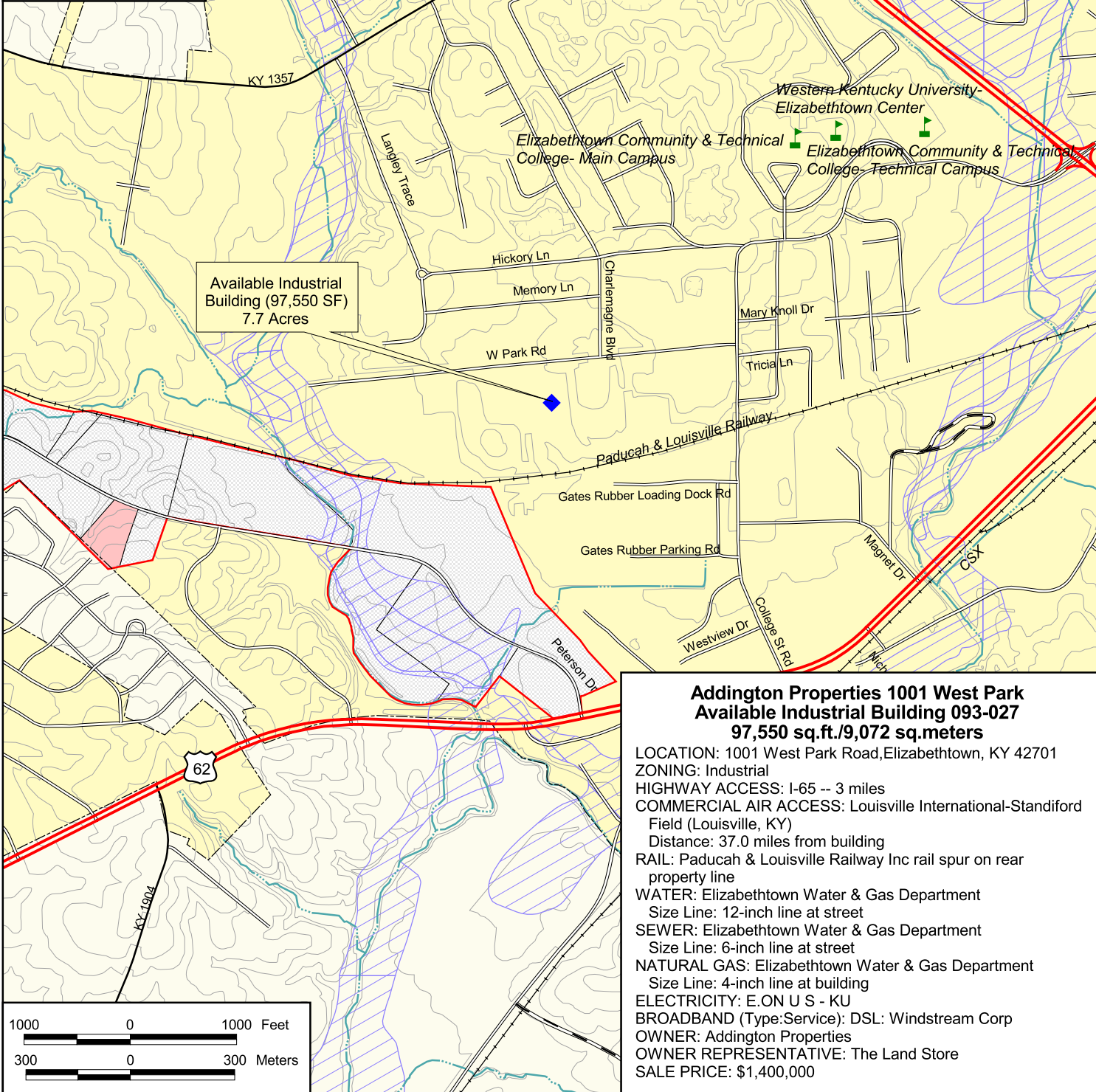

Available Industrial Building (97,550 SF)
7.7 Acres

**Addington Properties 1001 West Park
Available Industrial Building 093-027
97,550 sq.ft./9,072 sq.meters**

LOCATION: 1001 West Park Road, Elizabethtown, KY 42701
 ZONING: Industrial
 HIGHWAY ACCESS: I-65 -- 3 miles
 COMMERCIAL AIR ACCESS: Louisville International-Standiford Field (Louisville, KY)
 Distance: 37.0 miles from building
 RAIL: Paducah & Louisville Railway Inc rail spur on rear property line
 WATER: Elizabethtown Water & Gas Department
 Size Line: 12-inch line at street
 SEWER: Elizabethtown Water & Gas Department
 Size Line: 6-inch line at street
 NATURAL GAS: Elizabethtown Water & Gas Department
 Size Line: 4-inch line at building
 ELECTRICITY: E.ON U S - KU
 BROADBAND (Type:Service): DSL: Windstream Corp
 OWNER: Addington Properties
 OWNER REPRESENTATIVE: The Land Store
 SALE PRICE: \$1,400,000

